

# THE FUTURE IS ELECTRIC.



## EV CABLES AVAILABLE NOW.

QUALITY YOU CAN  
TRUST EVERY TIME.

#apecautomotive  
[www.apecautomotive.co.uk](http://www.apecautomotive.co.uk)

# THE FUTURE

# IS NOW.

Explore our brand new range of Electric Vehicle (EV) charging cables. TUV Certified & IP54 rated to support drivers in an ever growing EV market. Our EV cables come in both single-phase and 3-phase applications, and is supplied with a handy storage carry case – another reason to choose Apec.

- Single-phase: operating voltage up to 240VAC
- 3-phase: operating voltage up to 415VAC
- 5 metre (16 ft) length, with an additional 5 metre extension option
- Operating temperature -30°C to 50°C
- Tested to 2,500 VDC
- IEC, TUV, UKCA and CE certified
- Supplied with storage case for safe transportation
- High-quality polycarbonate (PC) handle with copper alloy contacts
- Suitable for most electric vehicles
- Waterproof to IP54



**DID YOU KNOW?**

Global EV sales up  
**108%**  
from 2020 to 2021\*

**54.8%**

of car parc will be  
new plug-in cars  
by 2035\*\*

\*Data sourced from SMMT.co.uk and correct at time of printing.

\*\*Data sourced from ev-volumes.com and correct at time of printing.

# WE'VE GOT YOUR TYPE.

## TYPE 1.

## TYPE 2.

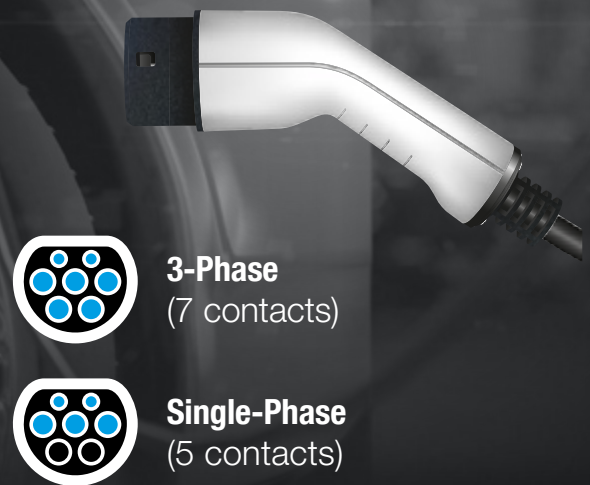

- 5 charging pins
- Manual locking catch.
- Can be unlocked by anyone
- Only single-phase
- Common on Japanese, Asian and US vehicles

- 5 or 7 charging pins
- No manual lock, locking pin keeps it in place. Can only be unlocked by owner/user
- Built in resistors to tell the vehicle the status of the charging process
- Available as single-phase and 3-phase for rapid charges
- Industry standard for UK and European made vehicles

# YOU'VE GOT **THE POWER.**

## DO I NEED A 16 AMP OR 32 AMP EV CHARGING CABLE?

With 16 Amp cables charging at a much slower rate, and the majority of modern charging stations being 32 Amp, it is much more cost effective to use a 32 Amp cable. 32 Amp charging cables can even be used in a 16 Amp charger meaning you do not need multiple cables depending on the outlet Amp.



## CONTROLLER

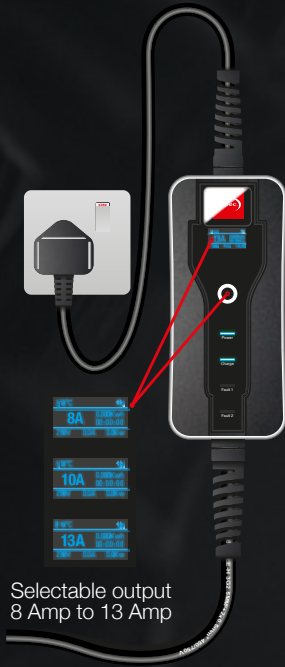

## HOUSING



## CABLE

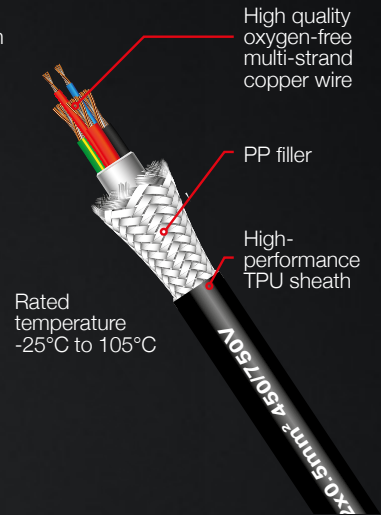

# SINGLE-PHASE OR 3-PHASE CABLE?



## DOMESTIC PROPERTY

**Usually single-phase supply:**  
Only single-phase cable required to charge EV's at home.

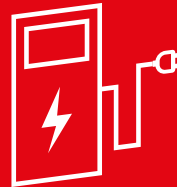

## PUBLIC CHARGING POINT

**Usually 3-phase supply:**  
3-phase cable is recommended.

**Note: 3-Phase EV cables can be used in both a single-phase and 3-phase charger. A single-phase 32 amp charger will charge at 7.4kw per hour. A 3-phase 32 amp charger will charge at 22kw per hour (3 x faster). The speed your electric vehicle charges at depends on the vehicle's onboard charger. Check vehicle manufacturer specifications for details.**

# AEC

## -101-



Type 2 Female  
to Type 2 Male



32  
AMP

UpTo  
415V

UpTo  
22 kW



Audi, BMW, Hyundai, Jaguar, KIA, Lucid Air, Mercedes, Mini, Nissan Leaf 2018, Porsche, Range Rover P400e, Renault, Smart, Tesla, Toyota, Volkswagen, Volvo

# AEC

## -102-



Type 1 Female  
to Type 2 Male



UpTo  
32  
AMP

UpTo  
240V

UpTo  
7.4 kW



Citroen C-Zero, Ford Focus Electric, Kia Soul EV, Mitsubishi I-MIEV, Mitsubishi Outlander PHEV, Nissan e-NV200 Combi, Nissan Leaf 2012 - 2017, Peugeot iOn, Renault Fluence, Toyota Prius, Vauxhall Ampera

# AEC

## -103-



Type 2 Female  
to UK Plug  
(with controller)



UpTo  
16  
AMP

UpTo  
240V

3.7 kW



Audi, BMW, Hyundai, Jaguar, KIA, Lucid Air, Mercedes, Mini, Nissan Leaf 2018, Porsche, Range Rover P400e, Renault, Smart, Tesla, Toyota, Volkswagen, Volvo

# AEC

## -104-



Type 1 Female  
to UK Plug  
(with controller)



UpTo  
16  
AMP

UpTo  
240V

3.7 kW



Citroen C-Zero, Ford Focus Electric, Kia Soul EV, Mitsubishi I-MIEV, Mitsubishi Outlander PHEV, Nissan e-NV200 Combi, Nissan Leaf 2012 - 2017, Peugeot iOn, Renault Fluence, Toyota Prius, Vauxhall Ampera

# THE RANGE.

## TRAVEL & HOME.



Household Outlet **3.7kW**

Single  
PHASE



16  
AMP

Typical charging times:

30kWh Battery - 8.5 hours  
60kWh Battery - 16.5 hours  
90kWh Battery - 24.5 hours

## TRAVEL & HOME.



# AEC

## -105-



Type 2 Female  
to Type 2 Male  
Extension Cable



Audi, BMW, Hyundai, Jaguar, KIA, Lucid Air, Mercedes, Mini, Nissan Leaf 2018, Porsche, Range Rover P400e, Renault, Smart, Tesla, Toyota, Volkswagen, Volvo

# AEC

## -106-



Type 2 Female  
to Type 2 Male  
Extension Cable



Audi, BMW, Hyundai, Jaguar, KIA, Lucid Air, Mercedes, Mini, Nissan Leaf 2018, Porsche, Range Rover P400e, Renault, Smart, Tesla, Toyota, Volkswagen, Volvo

# AEC

## -107-



Type 2 Female  
to Type 2 Male



Audi, BMW, Hyundai, Jaguar, KIA, Lucid Air, Mercedes, Mini, Nissan Leaf 2018, Porsche, Range Rover P400e, Renault, Smart, Tesla, Toyota, Volkswagen, Volvo

# AEC

## -108-



Type 2 Female  
to 32A Commando  
(with controller)



Audi, BMW, Hyundai, Jaguar, KIA, Lucid Air, Mercedes, Mini, Nissan Leaf 2018, Porsche, Range Rover P400e, Renault, Smart, Tesla, Toyota, Volkswagen, Volvo

## Wall Box/Public Charger 7.4kW



Typical charging times:

30kWh Battery - 4.5 hours  
60kWh Battery - 8.5 hours  
90kWh Battery - 12.5 hours

## FAST CHARGE PUBLIC. Wall Box/Public Fast Charger 22 kW

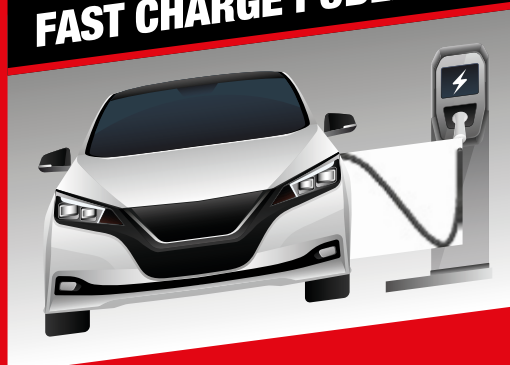

Typical charging times:

30kWh Battery - 1.5 hours  
60kWh Battery - 3 hours  
90kWh Battery - 4.5 hours

# CHARGING TIMES EXPLAINED.

# APEC

# EVOLVED.

At Apec we are constantly striving to improve the product & service available to our valued customers, that work never stops.



**PIONEERING**  
INNOVATION & SUPPORT



**DEVELOPING**  
EXPERTISE FROM HERITAGE

**TRUSTED**  
PRODUCT QUALITY



**UNRIVALLED**  
STOCK MANAGEMENT



## TALK TO TECHMATE

The TECHMATE team are ready to support you every step of the way. You can contact the TECHMATE helpline at 01174 288090 or email [technical@apecautomotive.co.uk](mailto:technical@apecautomotive.co.uk) for product support.

**TECH  
MATE**

## GET IN TOUCH

You can follow us on our social channels by searching @apecautomotive. Alternatively, you can contact our support team for assistance on 0117 429 8100 or email [info@apecautomotive.co.uk](mailto:info@apecautomotive.co.uk).

– #apecautomotive –

